

## HEEE Series, Crimp Connection, 128 pin, Male insert

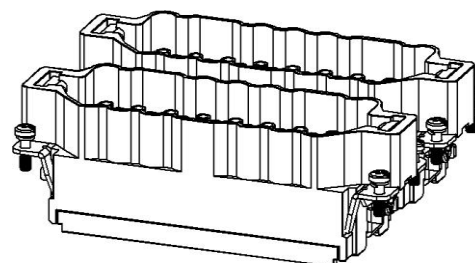
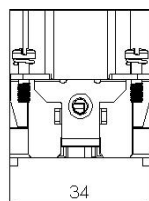
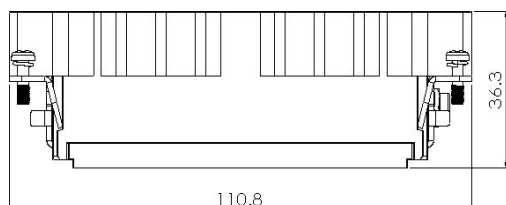

**Typecode**      HEEE-128-MC  
**ID**                1 007 03 0000148

### 技术数据

#### Product Properties

Series	HEEE
Mating with	H48B
Connection mode	Crimp termination
Gender	Male
Rated voltage	500 V
Rated current	16 A
Rated impulse voltage	6 kV
Mating contact	16 A(ESM/EGM)
Number of pins	128
Core cross-section/Clamping ability	0.14~ 4 mm <sup>2</sup> /26 AWG ~ 12 AWG
Grounding conductor	Yes
Pollution degree	3
Insulation resistance	≥ 10 <sup>10</sup> Ω
Limiting temperature	-40 °C ~ +125 °C
Standard	EN 60664-1, IEC 61984

#### Insert

Material	PC
Colour	RAL 7032

#### Commercial data

Weight	0.146 kg
Packaging unit	5 pc
Country of origin	CN

\*这里所列的是设计数据, 有关产品的变更不在此做说明, 未尽事宜请联系客服。用户有责任验证功能、符合适用的法律和指令以及在特定应用中的电气安全。

### Features

- High quality engineering plastics
- Crimp termination
- ≥ 500 Mating cycles
- Approval: CE
- RoHS-compliant

## HEEE Series, Crimp Connection, 128 pin, Femle insert

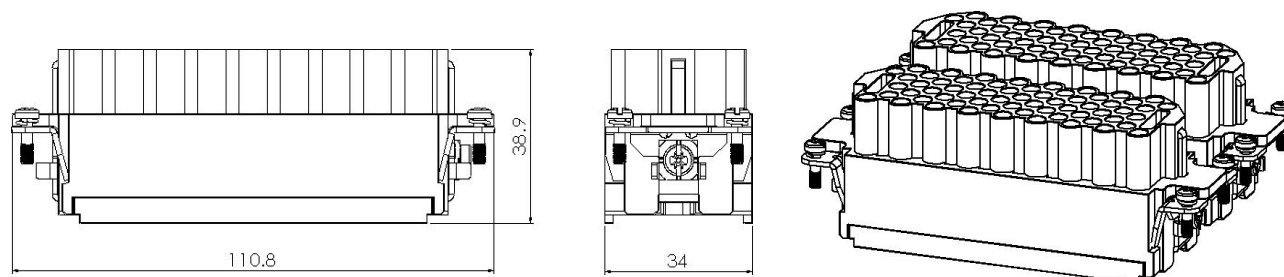

Typecode **HEEE-128-FC**  
ID **1 007 03 0000147**

### Technical Data

#### Product Properties

Series	HEEE
Mating with	H48B
Connection mode	Crimp termination
Gender	Femle
Rated voltage	500 V
Rated current	16 A
Rated impulse voltage	6 kV
Mating contact	16 A(ESF/EGF)
Number of pins	128
Core cross-section/Clamping ability	0.14~ 4 mm <sup>2</sup> /26 AWG ~ 12 AWG
Grounding conductor	Yes
Pollution degree	3
Insulation resistance	≥10 <sup>10</sup> Ω
Limiting temperature	-40 °C ~ +125 °C
Standard	EN 60664-1, IEC 61984

#### Insert

Material	PC
Colour	RAL 7032

#### Commercial data

Weight	0.160 kg
Packaging unit	5 pc
Country of origin	CN

\*这里所列的是设计数据，有关产品的变更不在此做说明，未尽事宜请联系客服。用户有责任验证功能、符合适用的法律和指令以及在特定应用中的电气安全。

### Features

- High quality engineering plastics
- Crimp termination
- ≥500 Mating cycles
- Approval: CE
- RoHS-compliant